

003-6050

MATERIAL. --

FINISH. --

REVISIONS				
ECO NUMBER	REVISION	REV DESCRIPTION	APPROVED	DATE
12489	A	DRAWING RELEASE	CRW	6/26/2009
12720	B	ADDED NOTES ABOUT LOCTITE LOCATION	CRW	8/27/2009

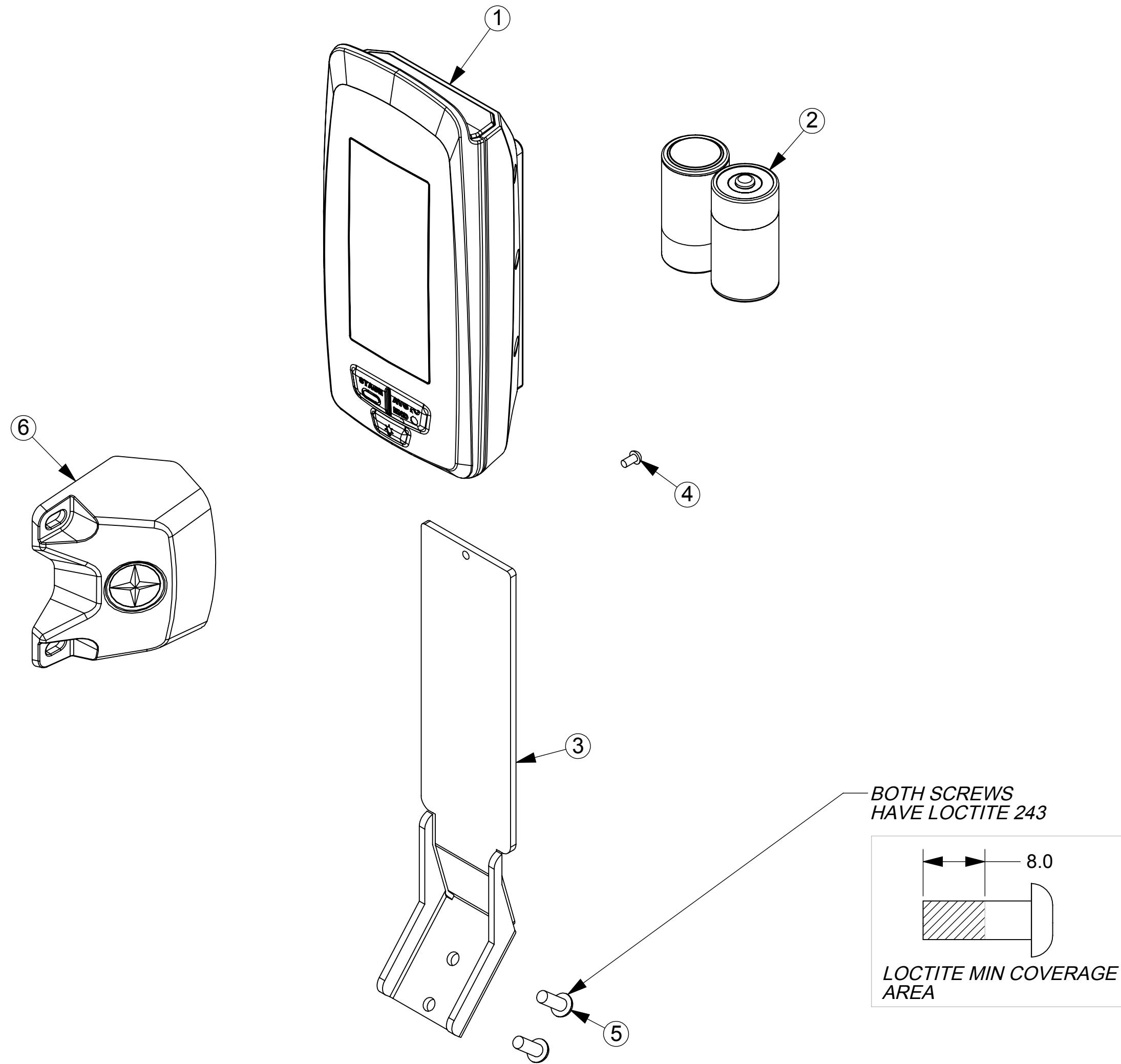

ENGINEERING J. BENDER
 APPROVAL 06/25/2009
 DRAFTING C. WISHON
 APPROVAL 06/25/2009
 INDUSTRIAL DESIGN J. GETTLE
 APPROVAL 06/25/2009

NAUTILUS
 NAUTILUS, INC.
 16400 SE NAUTILUS DRIVE, VANCOUVER, WA 98683
 CONTACT

UNLESS OTHERWISE SPECIFIED:
 1. ALL DIMENSIONS APPLY BEFORE PLATING OR COATING.
 2. REMOVE ALL BURRS. BREAK SHARP EDGES 0.5 MM MAX.
 3. ALL MACHINES SURFACES Ra 3.2 μM.
 4. ALL APPLICABLE NAUTILUS STANDARDS AND SPECIFICATIONS APPLY.

METRIC THIRD ANGLE PROJECTION

TOLERANCES:
 X. ± 3
 X.X ± 0.5
 X.XX ± 0.25
 X.XXX ± 0.1
 ANGULAR ± 1°

DESIGNED C. WISHON
 DRAWN C. WISHON
 DATE 06/25/09

DO NOT SCALE DRAWING

TITLE: **MPOWER CONSOLE PACKAGED ASSY**
 SIZE: **C** PART NO. **003-6050** REV. **B**

ITEM	Default QTY.	PART NO.	DESCRIPTION
1	1	002-2438	CONSOLE ASSEMBLY
2	1	003-5722	C-BATTERIES_QTY2
3	1	002-2437	CONSOLE BRACKET
4	1	902-5525	SCW-RHP M3x0.5x6 SS
5	2	902-4999	SCW-BHCS M5x0.8x14 SS
6	1	002-2341	SPEED SENSOR ASSEMBLY